



BIOLINE

JATÒ



BODY CONCEPT

Feel good, Look good

PROFESSIONAL MANUAL

Index

The new form of well-being: Feel Good, Look Good	5
Physiological Changes	6
Functional Complexes	8
The Bioline Jatò® System Method	12
Bioaromas	13
Body Beauty Experience - The manual skills	14
Bioline Jatò Professional Treatments	17
The Renewing Power and the importance of Proper Hydration - Exfoliation and Moisturization of the body - The products	18
Exfoliating Treatments - Exfo Marine and Glyco Peel	19
Cellulite, Adiposity and Skin Laxity - Meso-Fit - The products	20
Meso-Fit Treatment	21
Brush Draining Massage - The manual skills	22
Infiltrated and Fibrous Cellulite - Algo-Cell - The products	24
Algo-Cell Treatment	25
Zero-Cell Stimulation - The manual skills	26
Compact Cellulite and Localized Fat - Coffee-Shape - The products	28
Coffee-Shape Treatment	29
Vacuum Lipo Massage - The manual skills	30
Localized and Widespread Adiposity - Adi-Shape - The products	32
Adi-Shape Treatment	33

Swollen Legs – Sculpt & Drn Bandage – The products	34
Sculpt & Drn Bandage Treatment	35
Localized Adiposity – Sculpt & Lipo Bandage - The products	36
Sculpt & Lipo Bandage Treatment	37
Bioline Jatò Body Massages	39
Homecare Products	42
Body Beauty Project	44
The Protagonists of the Body Beauty Project	46
The Paths of the Body Beauty Project	48
Warnings	51



BODY CONCEPT
THE NEW FORM OF WELL-BEING

Feel good, Look good

A complete line of safe and effective **professional and homecare references** that, wisely combined with **specific protocols**, allow to live unique sensory experiences for a reshaped and fit body.

The exclusive **Bioline Jatò® System** method is at the heart of all treatments: it ensures performance and long-lasting results thanks to a physiologically balanced sequence of manoeuvres. It involves three sequential and synergic steps that open and close all body treatments, enhancing its efficacy.

Specific and functional treatments and exclusive manoeuvres maximize the results of each session and allow to create personalized paths according to needs and blemishes.

More than 40 years of experience have allowed Bioline Jatò to develop the **BODY BEAUTY PROJECT**: a tested working protocol that allows to identify the most suitable path for each customer, aiming specifically any blemish, for immediately visible and long-lasting results.

Body Concept is the versatile, flexible and proven efficacy for a fit body, **all year round**.

THE STUDY OF BODY BLEMISHES



Physiological Changes

Body blemishes - **fat deposits, “orange peel” skin and sagging skin** - are the results of physiological changes that have also a negative impact on the individual's overall state of well-being.

They can appear on various parts of the body in different periods of our lives, affecting **over 90% of women** from puberty onwards.

More than one type and form of a variety of blemishes can co-exist **at the same time** on the same person and this requires different **specific actions**, in addition to an on-going treatment path.

THE STUDY OF PHYSIOLOGICAL MECHANISMS AND THE CORRECT ANALYSIS OF BLEMISHES ARE AT THE BASE OF BIOLINE JATÒ RESEARCH TO OFFER SUCCESSFUL BEAUTY TREATMENTS.



CELLULITE, FAT AND SAGGING SKIN¹

CELLULITE or EFP (Edematous Fibrosclerotic Panniculopathy):

- **Alteration of the skin tissue caused by multiple factors:** diet and incorrect life style, hormonal imbalance, hereditary factors.
- The initial stage manifests itself with accumulation of excess liquid in the skin tissues (edema) lead by the **change in blood and lymph circulation.**

ADIPE

- **Increase in volume and in the number of adipose cells,** without altering the structure or function of the skin tissue.

SKIN SLACKENING

- Degeneration and decrease of protein fibres which support the skin, elastin and collagen, cause loss **of firmness and elasticity.**
- The areas of the body commonly affected are: inner **thigh and arms, the abdomen, buttocks and breasts.**



COMPACT CELLULITE AND LOCALIZED FAT³

COMPACT CELLULITE

- The skin is **adherent to the muscle tissue** and has a **slightly mobile appearance;** it is not easy to hold the affected part in your hands because it is very firm.
- It can occur in both overweight and physically fit subjects (athletes) and often also in young girls.

LOCALIZED FAT

- Localized increase in the **“healthy” adipose tissue,** which has a smooth appearance and may increase or decrease based mainly on energy intake.



INFILTRATED AND FIBROUS CELLULITE²

INFILTRATED CELLULITE

- Manifests itself with swelling around the **ankles, shins and thighs.**
- The accumulation of excess liquid may be a temporary phenomenon or become chronic.

FIBROUS CELLULITE

- Because of liquids penetrating the tissue, the **adipose cells** are altered and **micro and macronodules** become perceptible to the touch.
- The surface of the skin takes on the typical **“orange peel”** or **“mattress”** look.



LOCALIZED AND WIDESPREAD FAT⁴

LOCALIZED FAT

- In **women,** the fatty mass is generally concentrated around the hips, buttocks and thighs whereas (**gynoid** conformation), in men it affects the abdomen (**android** conformation).

WIDESPREAD FAT

- The fatty mass is distributed evenly **throughout the body.**

1. Blemishes caused by cellulite, localized adiposity, sagging skin 2. Blemishes caused by infiltrated and fibrous cellulite
3. Blemishes caused by compact cellulite and localized fat 4. Blemishes caused by localized and widespread fat deposits

Functional Complexes

The **effectiveness** of **Bioline Jatò** treatments is primarily due to the ongoing biotechnological research and the strong focus on innovation that have been the hallmark of the company's laboratories for over forty years. The selection of **superior functional substances**, the combination with **versatile complexes**, and use of the best methods of penetration and release times **exclusive multifunctional complexes** allow an intensive and selective action.



CELLULITE, FAT AND SAGGING SKIN¹

BODY FIT COMPLEX
MARINE BIOTECH EXTRACT,
CAFFEINE AND CARNITINE



DOUBLE EFFICACY AIMED TO BLEMISHES DUE TO
ADIPOSYTY AND SAGGING SKIN

Multifunctional complex that, like a true **personal trainer**, reduces the look of localized adiposity and promotes the cutaneous elasticity for a **lighter silhouette** and a more defined body shape.

SPIRULINA ALGAE
ARTHROSPIRA MAXIMA



SUPERFOOD RICH IN VEGETAL PROTEINS AND
CHLOROPHYL

Algae with a characteristic spiral shape of blue-green colour. It contains up to **70% proteins** and is also rich in vitamins, mineral salts e **chlorophyll**. It has **detox, protective and draining properties**.

INFILTRATED AND FIBROUS CELLULITE²

NIOCELL COMPLEX
CAFFEINE, COLEUS FORSKOLHII EXTRACT,
BETA-AESCIN



FOR TARGETED ACTION TO THE BLEMISHES OF THE
CELLULITE AND WATER RETENTION

Innovative functional complex with draining action composed of Caffeine, Coleus Forskolhii Extract and Aescine Encapsulated within special ultradeformable elastic vesicles (**niosomes**), which promote the the absorption and gradual release of the active ingredients for an **enhanced effectiveness**.

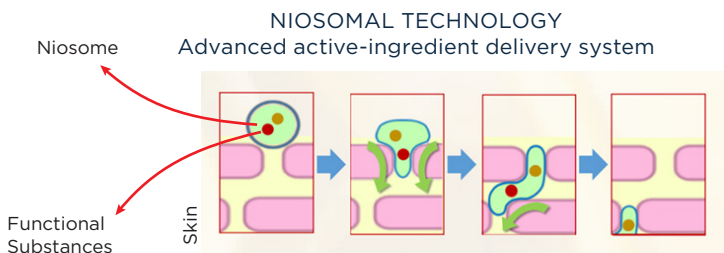

CELL-REVERSE SEAWEED
ALGA SPHACELARIA SCOPARIA

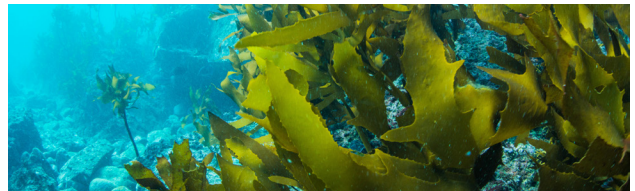

BLUE TECHNOLOGY
THE INNOVATION THAT COMES FROM THE SEA

Marine-origin functional substances characterized by their **high concentration**, sustainability and **effectiveness**.

The **Bioline Jatò** laboratories have selected a special Mediterranean brown algae, Sphacelaria scoparia extract, which target blemishes linked to **cellulite** and **water retention**.

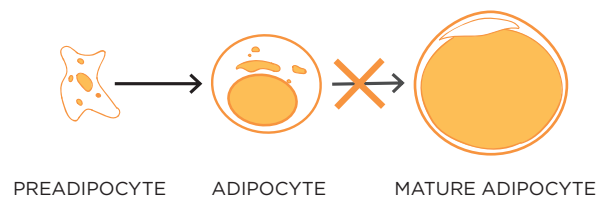

1. Blemishes caused by cellulite, localized adiposity, sagging skin 2. Blemishes caused by infiltrated and fibrous cellulite

COMPACT CELLULITE AND LOCALIZED FAT³

PURE CAFFEINE AND COFFEE SILVERSKIN



COFFEE, THE STAR INGREDIENT AIMED AT THE BLEMISHES OF CELLULITE AND ADIPOSITY

Caffeine helps to **reactivate the drainage of liquids and favours the reduction of localized fat accumulation***.

Coffee Silverskin, a natural **upcycled** ingredient obtained from the silver film that protects the coffee bean, **moisturizes** and promotes the **skin barrier function**.

* A. Herman A.P. Herman: Caffeine's Mechanisms of Action and Its Cosmetic Use. Skin Pharmacol Physiol 2013;26:8-14.

MACA



A SUPERFOOD WITH A POWERFUL ENERGIZING AND REMODELLING EFFECT, ORGANIC AND FROM SUSTAINABLE SOURCES

Upcycled extract obtained from Peruvian Maca leaves (*Lepidium Meyenii*), rich in polyphenols. It's **specific for fat deposits** and blemishes due to **cellulite** and improves skin firmness. It improve also the drainage and blood microcirculation.

LOCALIZED AND WIDESPREAD FAT⁴

NIOSHAPE COMPLEX CAFFEINE, POMEGRANATE SEED EXTRACT, SOY ISOFLAVONES



RESHAPES THE BODY CONTOURS,
IMPROVING SKIN FIRMNESS

Powerful synergy of functional substances with a **remodeling action**, encapsulated within special elastic vesicles (**niosomes**), which promote the absorption of the functional substances, increasing their **effectiveness**.

LIPOREDUCER COMPLEX CAFFEINE, CARNITINE, ESCIN, IVY AND RUSCUS (BUTCHERBROOM) EXTRACTS, TEA-HYDROIODIDE AND TRIPEPTIDE-1

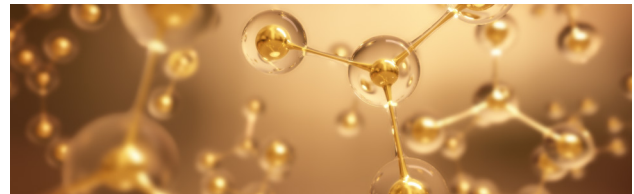

REDUCES THE VISIBILITY OF THE MOST STUBBORN FAT ACCUMULATIONS AND PREVENTS THEM FROM REAPPEARING

Multifunctional complex characterized by a high concentration of **active ingredients** in liposomal form. The advanced delivery method, composed by **multivesicular liposomes**, exploits the excellent penetration of the functional substances, ensuring **maximum effectiveness and a prolonged release**.

3. Blemishes caused by compact cellulite and localized fat 4. Blemishes caused by localized and widespread fat deposits

Research and Innovation to support Effectiveness

**HIGH-PERFORMANCE
FUNCTIONAL INGREDIENTS**

**NATURE, BIOTECHNOLOGICAL RESEARCH
AND SCIENTIFIC METHOD**

**EFFECTIVE,
SKIN-FRIENDLY PRODUCTS**

**IMMEDIATE, VISIBLE AND
LONG-LASTING RESULTS**



EXCLUSIVE AND EFFECTIVE FORMULAS

The Bioline Jatò® System Method

It is an exclusive and certified¹ working method. A balanced sequence of manoeuvres that, integrated in every professional treatment, ensures the best **performance and long-lasting results**.

The method is based on the **perfect synergy** between highly effective **products**, application **protocols** and exclusive **massages**.

It involves **three steps**, specifically designed to prepare the customer to relaxation, improve microcirculation, drainage and skin regeneration.

BIOLINE JATÒ® SYSTEM STEP 1

PREPARE FOR THE TREATMENT

Body Beauty Experience Relaxing and Draining Touch.

Relaxing and **decontracting** manoeuvres dissolve tensions, oxygenate the tissues, prepare the customer to a deep state of relaxation.

Draining pumps promote the flow of lymphatic current and detoxify tissues. The skin receptiveness is increased, favouring the absorption of active ingredients.

BIOLINE JATÒ® SYSTEM STEP 2

SPECIFIC TREATMENT

It involves the sequential application of the most suitable products for the treatment targeted to the blemish: **exfoliants, concentrates, wraps and bandaging, massage products**.

BIOLINE JATÒ® SYSTEM STEP 3

ENHANCE AND PROLONG THE RESULTS

Body Beauty Experience Firming Touch.

Stimulating and progressive **pressures** at the end of the treatment to **oxygenate the skin** and **tone the muscles**.

Body Beauty Experience



At the core of the **Bioline Jatò® System** lie the **BODY BEAUTY EXPERIENCE Relaxing, Draining and Firming Touch**, sequential specific manoeuvres that characterize the opening and closing of each single treatment.

Since they have always been an integral part of the Bioline Jatò method, they have been renewed to enhance their effectiveness, their ease of use and to create a complete, instantly recognizable **“beauty and well-being experience” developed by Bioline Jatò**.

1. Bioline Jatò® System is guaranteed by quality certification ISO 9001:2015 IGQ IQNET

THE ESSENCE OF WELL-BEING

Bioaromas

Synergies of highly effective essential oils that, in combination with the sequences of the **BODY BEAUTY EXPERIENCE**, infuse the desired functional footprint through selected active and olfactory notes.



BIOAROMA RELAXING EQL OIL

patchouli / chamomile / sandalwood / ylang ylang / white thyme

30 ml - 1.0 fl. oz US

For all types of skin

Blend of precious essential oils for a fragrance that **relaxes**, freeing the body from tension and restoring harmony and well-being.

HOW TO USE: apply a few drop on the areas most prone to tension.

BIOAROMA NORMALIZING DTX OIL

juniper / sage / lemon / tuya

30 ml - 1.0 fl. oz US

For impure and asphyctic skin

An extraordinary concentration of essences, specifically designed for skin normalization and oxygenation. For a **bright and even skin**.

HOW TO USE: apply a few drops on the areas with blemishes caused by cellulite or fatty deposits.

BIOAROMA ENERGY DRN OIL

orange / lemon / niaouli / white thyme

30 ml - 1.0 fl. oz US

For dull and devitalized skin

Concentrate of natural essences that **normalizes and purifies the skin**, for a regenerating, stimulating sensation.

HOW TO USE: Apply a few drops to the area around the lymph nodes and on the areas with greatest water retention.

BIOAROMA SOFTENING DEC OIL

lavender / chamomile / lemon balm / sandalwood

30 ml - 1.0 fl. oz US

For sensitive, dull, subject to fragile capillaries

A precious synergy of aromatic essences with softening properties soothes, **hydrates and improves elasticity** by reinforcing cutaneous tissues.

HOW TO USE: apply a few drops to the most sensitive areas or those affected by loss of skin tone, such as buttocks, inner thigh and inner arms.

WARNINGS: due to the intense aesthetic action, concentration and high level of permeation, the Bioaromas should be used sparingly, differentiating between application areas based on the imperfection. Do not apply to broken or weeping skin, during pregnancy and breast-feeding.

Body Beauty Experience

RELAXING TOUCH

Apply a few drops of **BIOAROMA Relaxing EQL OIL** along the spine, buttocks, biceps femoris, calf muscles (unless otherwise indicated).

HEAD OF THE MESSAGE TABLE

1. Heating frictions with two hands along paravertebral grooves

ON THE SIDE OF THE MESSAGE TABLE

2. Heating frictions with two hands perpendicular to the spine and on trapezius muscle
3. Heating of sacrum using hands borders
4. Crisscross roulage on sacrum
5. Alternated friction along the posterior part of iliac crest
6. Roulage from lumbar area and backwards
7. Short roulage along paravertebral grooves and backwards
8. Crisscross strokes on the whole back

REPEAT THE MOVEMENTS ON THE OTHER SIDE STARTING FROM POINT 2

9. Circular stimulation on central point of gluteus muscle with elbow
10. Stimulation on many points along gluteus line using thumb
11. Circular frictions with thumbs along internal and external line of femoral biceps
12. Perpendicular decontraction to femoral biceps with fingertips
13. Circular frictions with thumbs on calf muscle
14. Perpendicular roulage to calf muscle with two hands

REPEAT THE MOVEMENTS ON THE OTHER SIDE STARTING FROM POINT 9

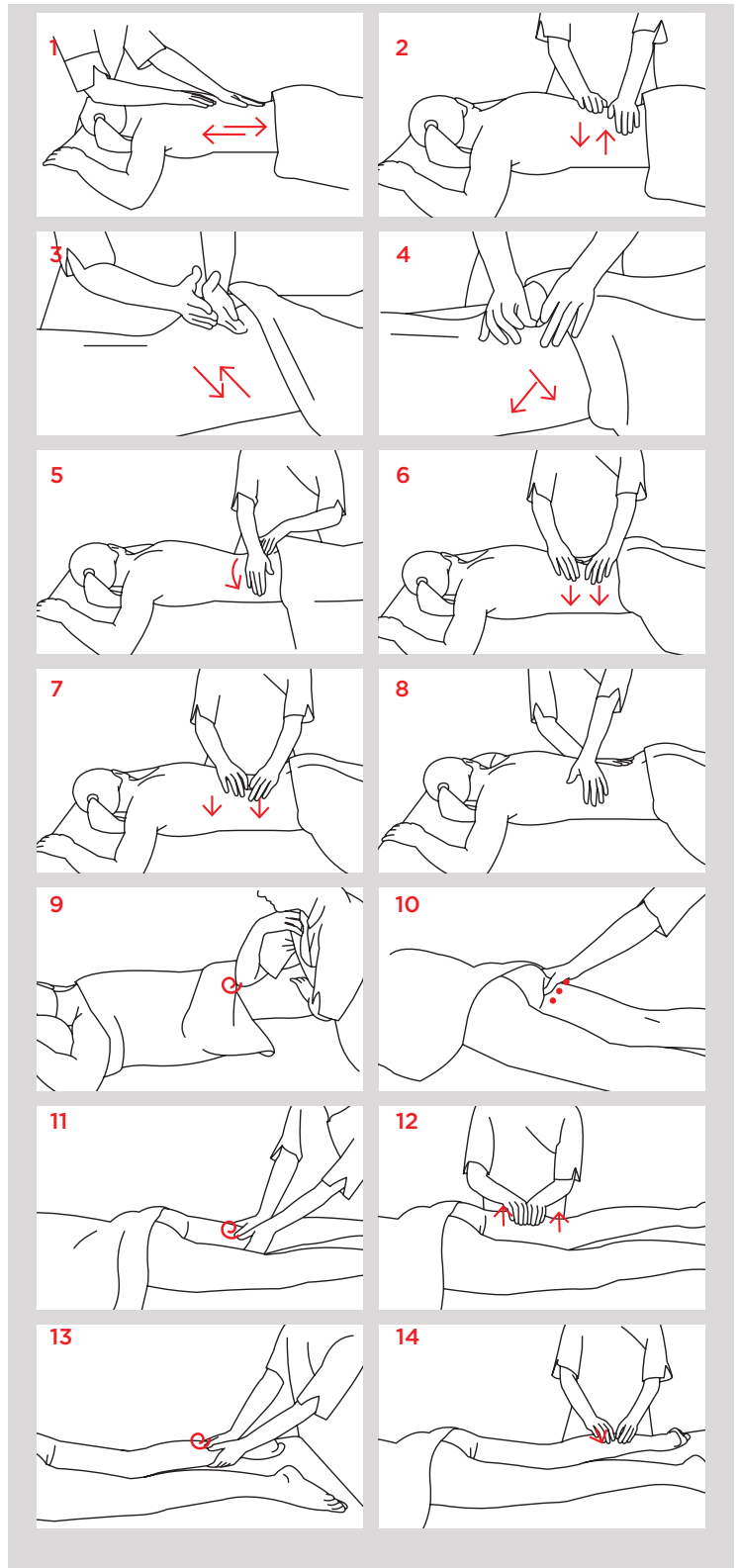

DRAINING TOUCH

Apply a few drops of **BIOAROMA ENERGY DRN OIL** on the main lymph node stations such as terminus, armpit, solar plexus, groin area, popliteal cavity and malleoli (unless otherwise indicated).

SUPINE POSITION

1. Pompage on terminus (in front of the client)
2. Pompage with full hand on pectoral muscle towards the armpit
3. Pompage on triceps towards armpit with one hand

REPEAT THE MOVEMENTS STARTING FROM POINT 2 ON THE OPPOSITE SIDE

4. Pompage on solar plexus (in front of the client)
5. Pompage on the groin area
6. Pompage on quadriceps
7. Pompage popliteal cavity
8. Pompage calf muscle
9. Pompage ankle bones

REPEAT THE MOVEMENTS-SEQUENCE STARTING FROM POINT 5 ON THE OPPOSITE SIDE

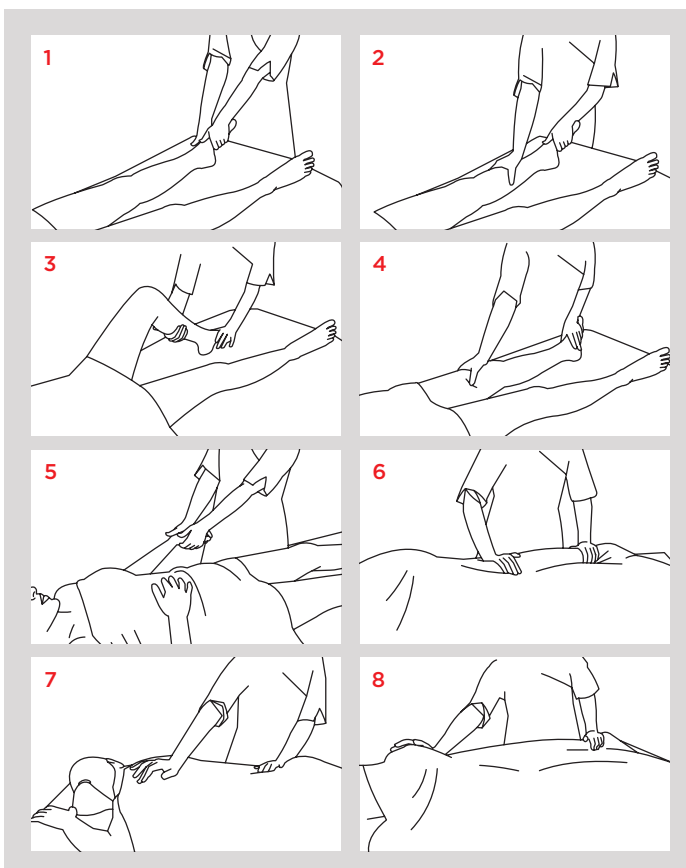
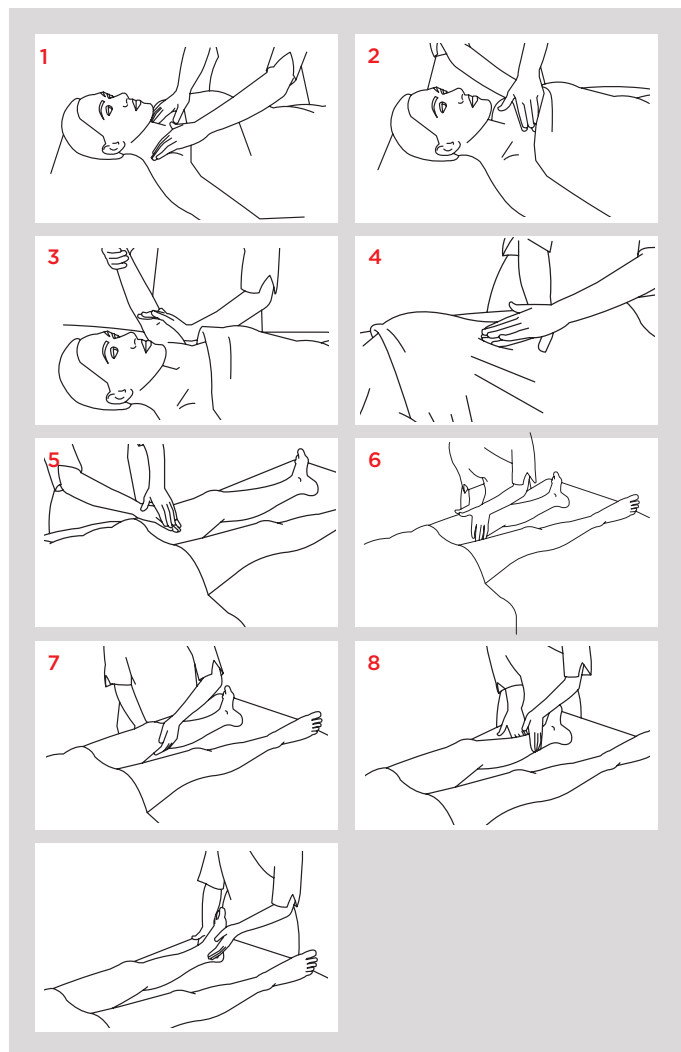

FIRMING TOUCH

WITHOUT ESSENTIAL OIL SUPINE POSITION

1. Starting from foot perform some pinching movements
2. Carry on with the movement along tibial crest
3. Along calf muscle (flexed leg)
4. On quadriceps

REPEAT ON THE OTHER LEG

5. Starting from the hand perform some pinching movement along the whole arm and repeat the sequence on the other side

PRONE POSITION

6. Cover with a towel and perform some pressure with full hand on the whole body
7. Back stretching
8. Legs stretching

POLINE
JATO



Professional Treatments

A consolidated offer of **specific and effective treatments** that combine **selected active ingredients, application protocols** and exclusive massages to ensure visible and long-lasting results.

BLEMISHES	TREATMENT	TREATMENT AREAS
THICKENED, ROUGH, DULL SKIN	EXFO MARINE / GLYCO PEEL	TOTAL BODY
CELLULITE, ADIPOSITY AND SKIN LAXITY	MESO-FIT	STOMACH, THIGHS, BUTTOCKS
INFILTRATED AND FIBROUS CELLULITE	ALGO-CELL	LOWER BODY
COMPACT CELLULITE AND LOCALIZED FAT	COFFEE-SHAPE	STOMACH, THIGHS, BUTTOCKS, LEGS
LOCALIZED AND WIDESPREAD ADIPOSITY	ADI-SHAPE	TOTAL BODY
SWOLLEN LEGS	SCULPT & DRN BANDAGE	LOWER BODY
LOCALIZED ADIPOSITY	SCULPT & LIPO BANDAGE	STOMACH, THIGHS, BUTTOCKS

The Renewing Power and Importance of Proper Hydration

BODY EXFOLIATION AND MOISTURIZATION

EXFO MARINE SCRUB SALT CRYSTALS

dead sea salts
centella extract
papaya extract
1000 g - 35.2 oz US

Formula with a rich oily gel texture which **provides softness and wellbeing to the skin**. Enriched with special salt crystals, it intensely renews and brightens the skin. A revitalizing effect for a smooth body, with minimized imperfections and roughness.

RECOMMENDED:

- for thick skin, before and after exposure to the sun
- combined with **Glyco Peel AHA Renewing Fluid** to treat different parts of the body at the same time
- combined with **Sculpt & Drn Bandage** for an intensified action on the lower limbs.

GLYCO PEEL AHA RENEWING FLUID

glycolic acid
ferulic acid
mandelic acid
200 ml - 6.7 fl. oz US

Special fluid peel, ideal for dull, matte, aged and relaxed skin. The high concentration of AHA **smoothes and renews the skin providing a radiant complexion**.

RECOMMENDED:

- for the more delicate parts of the body - breasts, bikini and under-arm areas
- for encouraging, aesthetically, the visible reduction of recently formed stretch marks
- locally on hyperpigmented areas and/or with skin discolouration
- on areas with sagging skin and/or stretch marks
- combined with **Exfo Marine Scrub Salt Crystals** to treat different parts of the body at the same time.

WARNINGS: if you feel excessive and prolonged tingling or redness, stop applying the product and remove it immediately, rinsing off with abundant water.

HYDRASOURCE BODY LOTION

pro-elasticity complex
aloe extract
white lily extract
rice milk
1000 ml - 33.8 fl. oz. US

Formula with a fresh, gently-fragranced texture that **nourishes and hydrates the skin intensely**, keeping it supple, radiant and soft. Enriched with extracts recognized for their soothing benefits, it **assures instant wellbeing**.

RECOMMENDED:

- for dull, sagging skin
- for performing **Bioline Jatò massages: Shaping, Jatòwell, DDM (Deep Draining Massage) and DTM (Deep Tissue Mobilization)**
- at the end of a hair removal session or after exposure to UV.





Exfoliating Treatment

EXFO MARINE

BODY BEAUTY EXPERIENCE*
Relaxing touch and **Draining touch**

- a) **Relaxing touch:** apply a few drops of **BIOAROMA RELAXING EQL OIL** to areas of greatest tension.
- b) **Draining touch:** applying a few drops of **BIOAROMA ENERGY DRN OIL** to the lymphatic ganglions.



EXFO MARINE

SCRUB SALT CRYSTALS

Mix and apply on the body 30-35 g of scrub.

Massage, concentrating on thickened areas (knees, elbows, heels).

Remove with microfibre cloth, shower or damp washcloths.

! To intensify the detoxifying action, it is recommended to use the product as a mask as well: wrap it in a disposable sheet and leave on for 10-15 minutes.



DRN ACTIVE ANTI-WATER CONCENTRATE or **LIPOACTIVE THERMOGENIC CONCENTRATE** depending on the blemish to be treated.

Apply 10 ml of the specific concentrate. Massage until absorbed.



DRN CELL OIL or **LIPOSHAPE CREAM** or **HYDRASOURCE BODY LOTION** depending on the blemish to be treated.

Apply 15-20 ml of specific product all over the body. Massage until absorbed.



Finish with the BODY BEAUTY EXPERIENCE **Firming touch***.

GLYCO PEEL

Perform the BODY BEAUTY EXPERIENCE* **Relaxing** and **Draining** touch without the use of **BIOAROMAS**.



GLYCO PEEL AHA RENEWING FLUID

Apply approximately 15-20 ml of product evenly over the body, using a brush or gloves.

Concentrate on areas with sagging skin and/or stretch marks.

Wrap in a disposable sheet and leave on for 10-15 minutes, depending on skin type.

Remove with microfibre cloth, shower or damp washcloths.

! Do not use on broken or sensitized skin. In case of prolonged redness or itching, remove the product immediately and rinse with water.



! See recommendations/warnings in the relevant professional products sections

*BBE details and sequences on pages 12-13-14-15

Cellulite, Adiposity and Skin Laxity*

MESO-FIT BROAD SPECTRUM TREATMENT CLINICALLY TESTED EFFECTIVENESS

DTX MASK

sea salts
glauicine
turmeric extract

500 ml - 16.9 fl. oz US

Intensive detox treatment **targeted to the blemishes linked to cellulite and fluid retention.** The high osmotic power of the sea salts and the purifying properties of the plant extracts reduce the appearance of orange peel skin redesigning its contours.

HOT GREEN MUD

spirulina
caffeine
centella extract

500 ml - 16.9 fl. oz US

A thermogenic mud-cream ideal for critical areas with a remodelling effect. The innovative, no-rinse formula combines the effectiveness of an algae mud with the ease of application of a cream. An **intensive treatment** that reduces the appearance of imperfections related to **fat deposits on the stomach, thighs, hips and buttocks.**

WARNINGS: it may cause a warming sensation that will disappear shortly. Wash hands thoroughly after the use.

ACTIVE GYM SERUM

body fit complex
phosphatidylcholine
vitamin E

250 ml - 8.4 fl. oz US

Intensive concentrated serum with double effectiveness. It **gives the body a toned appearance and more defined contours** thanks to an innovative functional complex that mimics the effects of physical exercise.



* Targets the appearance of cellulite and localized fat deposits



Discover More

Meso-Fit Treatment

STEP 1: BRUSH DRAINING MASSAGE* with BIOAROMA RELAXING EQL OIL and ENERGY DRN OIL

Perform the BRUSH DRAINING MASSAGE with the specific brush with natural bristles.
! This phase replaces the Body Beauty Experience Relaxing and Draining touch.



STEP 2: DTX MASK

Heat approximately 50 ml of product in a bain-marie or towel warmer.
Apply it with hands on the affected areas, performing long and enveloping strokes.
Wrap with a disposable sheet and leave on for 10'.
Remove with a microfiber cloth or damp washcloths.



STEP 3: HOT GREEN MUD

Apply approximately 50 ml of product in a thin and even layer on the affected areas with energetic movements of the hands.
Wrap in a disposable sheet and leave on for 15' without thermosauna or thermal blanket.
Massage until absorbed.
Dab off any product residue.
! WARNING: may cause temporary sensation of heat. Wash your hands thoroughly after use.



STEP 4: ACTIVE GYM SERUM and BODY BEAUTY EXPERIENCE Firming touch*

Massage approximately 25 ml of product on the affected areas.
Finish with the BODY BEAUTY EXPERIENCE **Firming touch**.

! See recommendations/warnings in the relevant professional products sections

*BRUSH DRAINING MASSAGE sequences on pages 22-23; BBE details and sequences on pages 12-13-14-15

Brush Draining Massage

The Brush Draining Massage is the functional massage that characterizes the **Meso-Fit treatment**. It is performed with a specific natural bristle brush and according to a specific protocol developed by Bioline Jatò.

It is ideal for:

- PROMOTING THE **ABSORPTION** OF FUNCTIONAL SUBSTANCES
- **SMOOTHING** AND EXFOLIATING THE TISSUES
- GETTING RID OF THE **IMPURITIES**, WASTE AND TOXINS
- FAVORING **DRAINING** REDUCING **STRESS** AND **TENSIONS**

PRONE POSITION

Apply a few drops of **Bioaroma Relaxing EQL Oil** along the spine, at the center of the gluteus, on the femoral biceps and on calf muscles. Eventually, apply a few drops of the **Bioaroma Normalizing DTX Oil** on the toxined areas.

LOWER LIMB

On the application areas of the **Bioaroma Relaxing EQL Oil** perform fast stimulating pressures upwards.

1. Long brushing from ankle towards the popliteal cavity, in more lines.
2. Short brushing on outer and inner thigh, directed towards the femoral biceps.
3. Long brushing on femoral biceps, towards the gluteal crease.
4. Short brushing towards the gluteal crease, upwards.
5. Semi-circular brushing along the gluteus, inward.

Repeat all the movements on the other side.

BACK

6. Radial brushing around the tailbone, inward and outward.
7. Short brushing on both sides of the back, towards the spine.
8. Long brushing on both sides of the back, in three sections.
9. Short brushing on trapezius, outward.

! It is recommended to perform all the manoeuvres continuously, without losing contact with the body or always alternating hand strokes and brushing.

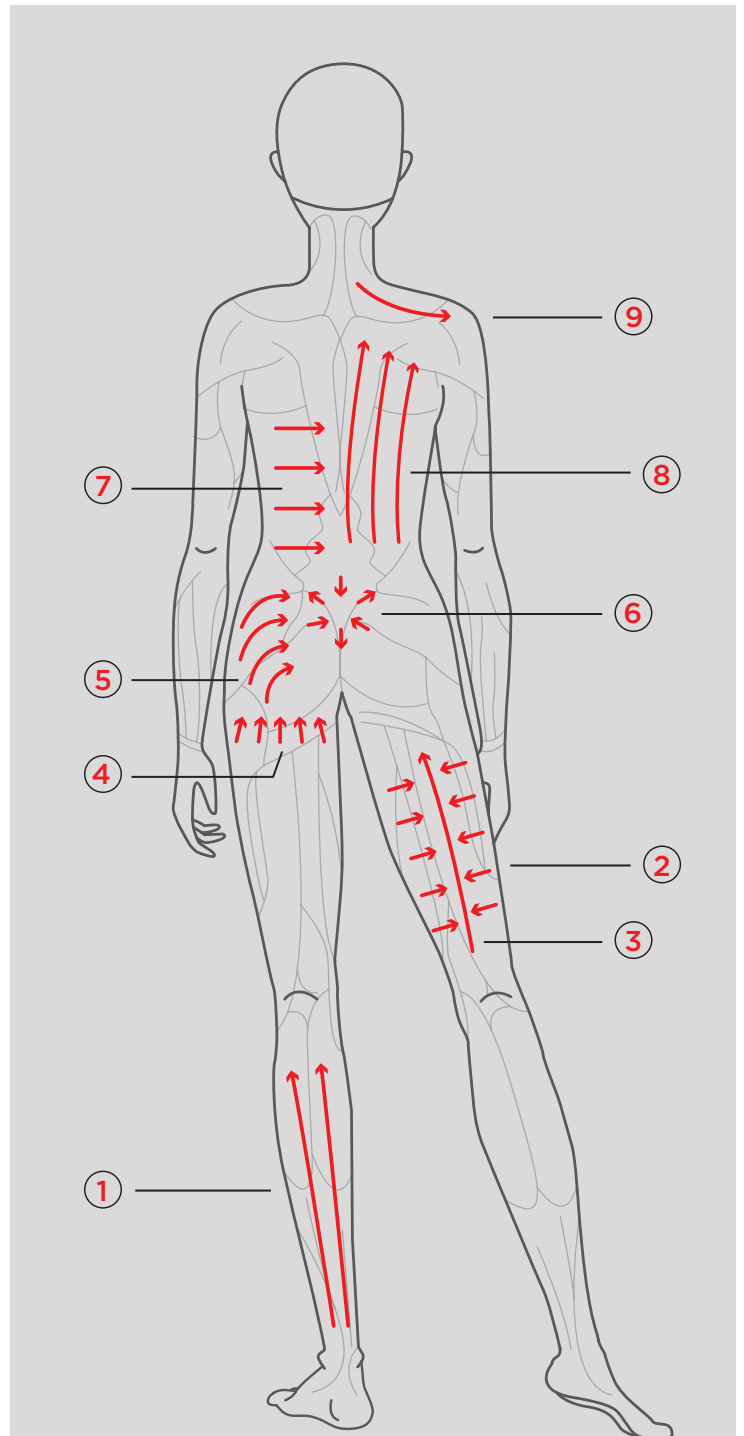



SUPINE POSITION

Apply a few drops of **Bioaroma Energy DRN Oil** on the main lymph nodes. Eventually, apply a few drops of **Bioaroma Normalizing DTX Oil** on the toxined areas.

LOWER LIMB

- 10. Long brushing from ankle to knee.
- 11. Radial brushing around the knee and short brushing towards the knee.
- 12. Short brushing on the inner thigh, towards the femoral quadriceps.
- 13. Long brushing from knee to groin.

Repeat all the movements on the other side.

ABDOMEN

- 14. Long brushing on both sides of the abdomen, towards the center.
- 15. Long brushing along the costal margin, outwards.
- 16. Long brushing, towards the pubic symphysis.

Repeat movements 15 and 16 on the other side.

- 17. Radius brushing around the belly, inwards and outward.
- 18. Circle brushing keeping the direction of the colon. Close with a vibrating brushing.

UPPER LIMB

- 19. Long brushing from the wrist to the elbow, both on the inner and outer forearm.
- 20. Long brushing from the elbow to the shoulder, both on inner and outer arm (limb bent).
- 21. At the head of the bed, perform a shoulder lowering.

! It is recommended to perform all the manoeuvres continuously, without losing contact with the body or always alternating hand strokes and brushing.

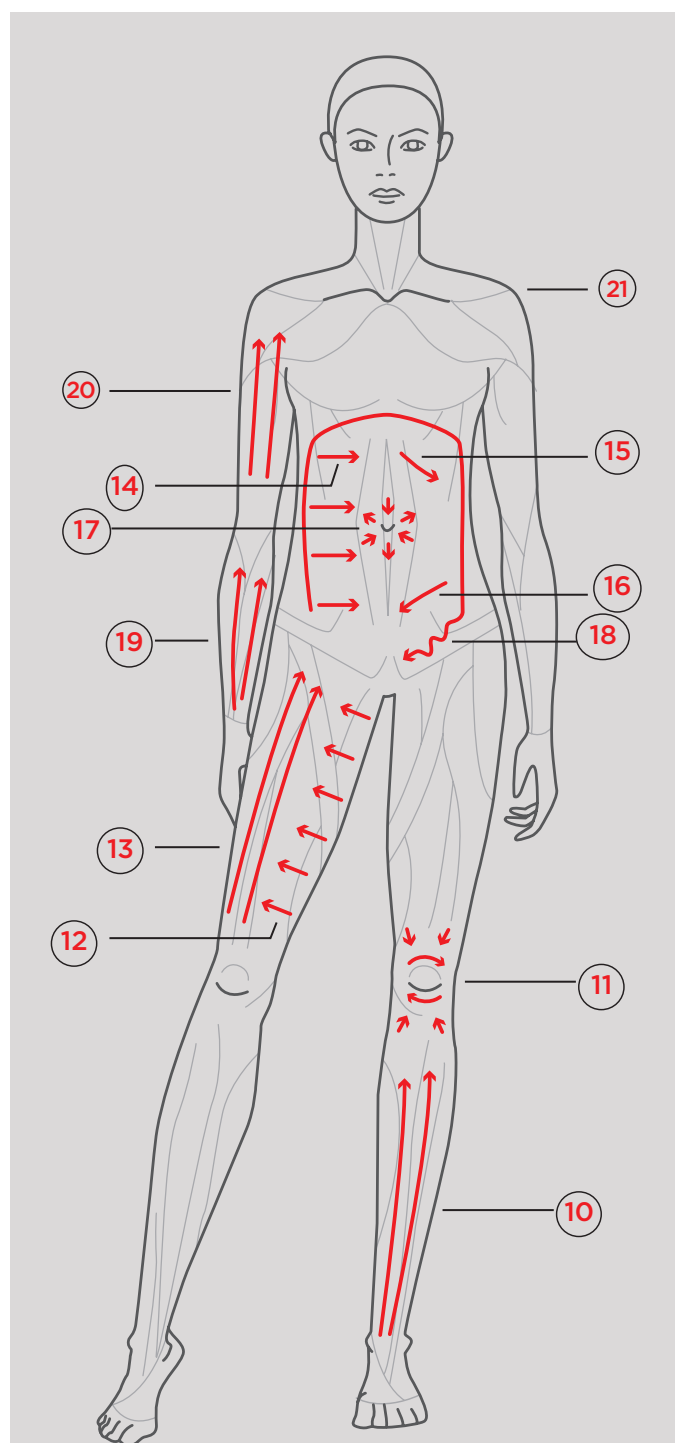

Infiltrated and Fibrous Cellulite*

ALGO-CELL TARGETED TREATMENT CLINICALLY TESTED EFFECTIVENESS

ALGO DRN SEA MUD

cell-reverse seaweed
brown algae extracts
sea salts
ruscus extract

1000 g - 35.2 oz US

A mud that **targets the critical points of the body** affected by imperfections caused by cellulite and water retention. The high osmotic exchange capability of the salts and the properties of the released functional substances in the mud help to **minimize the appearance of orange peel skin**.

WARNINGS: the mud can separate from water on its surface. Slight separation of the mud is natural and does not alter the product's properties. If this occurs, mix the product before use.

! FOR A MORE INTENSE DRAINING ACTION, IT IS RECOMMENDED TO APPLY SCULPT & DRN BANDAGE ON TOP OF ALGO DRN SEA MUD



ALGO-CELL SERUM

fucus
metilxantine
niocell complex

150 ml - 5.0 fl oz US

A concentrate of algae and active ingredients to be massaged for an intensive **anti-water effect**. Visibly reduces the blemishes caused by **cellulite** and **water retention** for a redefined silhouette. With innovative **Nio-somal Technology** for enhanced effectiveness.



DRN CELL OIL

escin
argan oil
ginkgo extract

500 ml - 16.9 fl.oz US

Precious plant oils **promote tissue elasticity** and help to maintain a **smoother skin** reducing the look of imperfections caused by cellulite. For a soft and hydrated skin.

RECOMMENDED:

- for very dry and dehydrated skin
- for performing **Bioline Jatò massages: Shaping, Jatòwell and DDM (Deep Draining Massage)**.



* Targets the blemishes caused by infiltrated and fibrous cellulite



Discover More

Algo-Cell Treatment

BODY BEAUTY EXPERIENCE Relaxing touch and Draining touch*

a) Relaxing touch: apply a few drops of BIOAROMA RELAXING EQL OIL to areas of greatest tension.

b) Draining touch: apply a few drops of BIOAROMA ENERGY DRN OIL to the lymphatic ganglions.



ALGO DRN SEA MUD

Warm up approximately 100 g of product in a bain-marie, add 10 ml of hot water and mix until soft and even.

Apply evenly on feet, legs, thighs and buttocks.

Wrap with a disposable sheet and leave on for approximately 15' with a thermal blanket.
Can be used with the thermosauna to encourage the exudative action.

Remove with microfibre cloth or shower.



ALGO-CELL SERUM

Apply approximately 15 ml of product on feet, legs, thighs and buttocks.

Massage with upwards draining strokes.



DRN CELL OIL and ZERO-CELL STIMULATION*

Apply 10 ml of product on treated areas and perform the ZERO-CELL STIMULATION.

! ZERO-CELL STIMULATION REPLACES BODY BEAUTY EXPERIENCE FIRING TOUCH WITH STIMULATING AND TONING ACTION.

! See recommendations/warnings in the relevant professional products sections

*BBE details and sequences on pages 12-13-14-15; ZERO-CELL STIMULATION sequences on pages 26-27

Zero-Cell Stimulation

A combination of manual techniques that deeply **stimulate the tissue** through a number of specific steps: warming friction, decontraction, detachment and percussion massage. These four steps **intensify and prolong treatments results**, enhancing their draining, modelling and lipolytic action. The **ZERO-CELL Stimulation** replaces the Body Beauty Experience Firming touch in the **Algo-Cell** and **Adi-Shape** treatments.

SUPINE POSITION - LOWER LIMBS

1. Two-handed warming friction along the sides of the tibial crest
2. Roulage from the outer tibia inwards
3. Hammer percussion massage along the outer tibia
4. Two-handed warming friction along the sides of the quadriceps femoris
5. Circular friction with knuckles along the sides of the quadriceps femoris
6. Roulage from the fascia lata inwards, both forwards and backwards
7. Pinching massage on the quadriceps femoris
8. Hammer percussion massage on the sides of the thigh

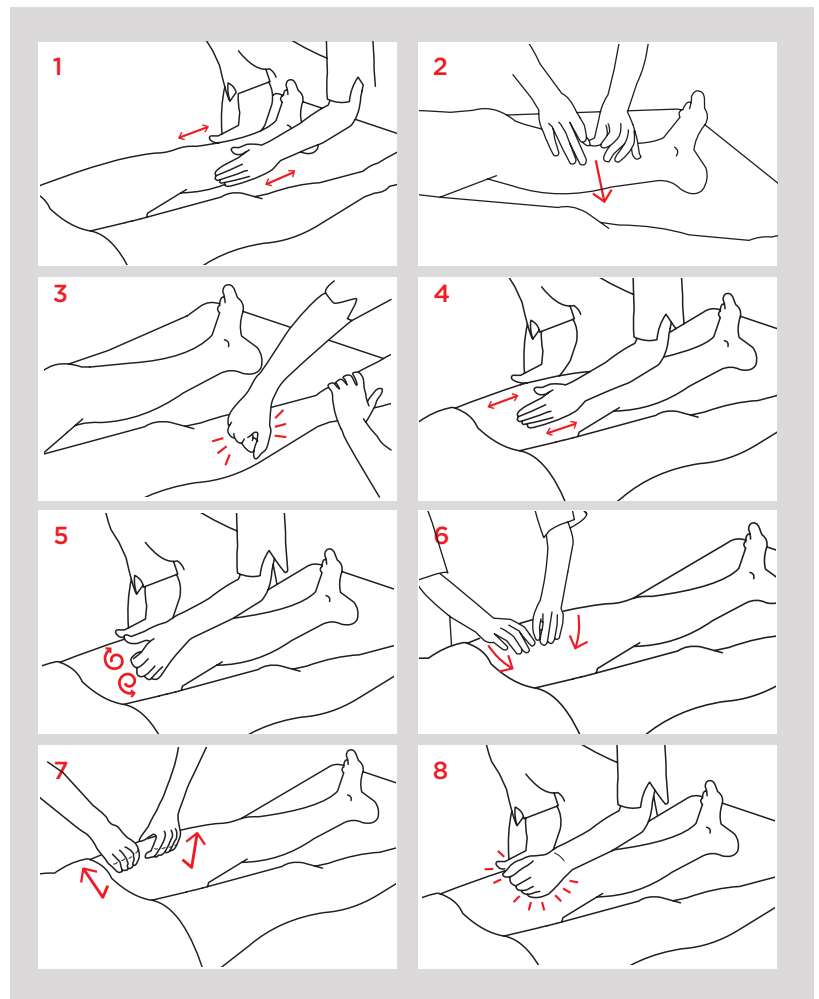

SUPINE POSITION ABDOMEN

1. Clockwise spiral motion around the navel
2. Roulage from linea alba outwards
3. Roulage on the rib arch outwards

Move to the other side and repeat movements 2 and 3

4. In a single movement, perform a distension of the rib arch with the fingertips, then wrap and define the sides of the abdomen and finish in direction of pubic symphysis
5. Deep colon massage

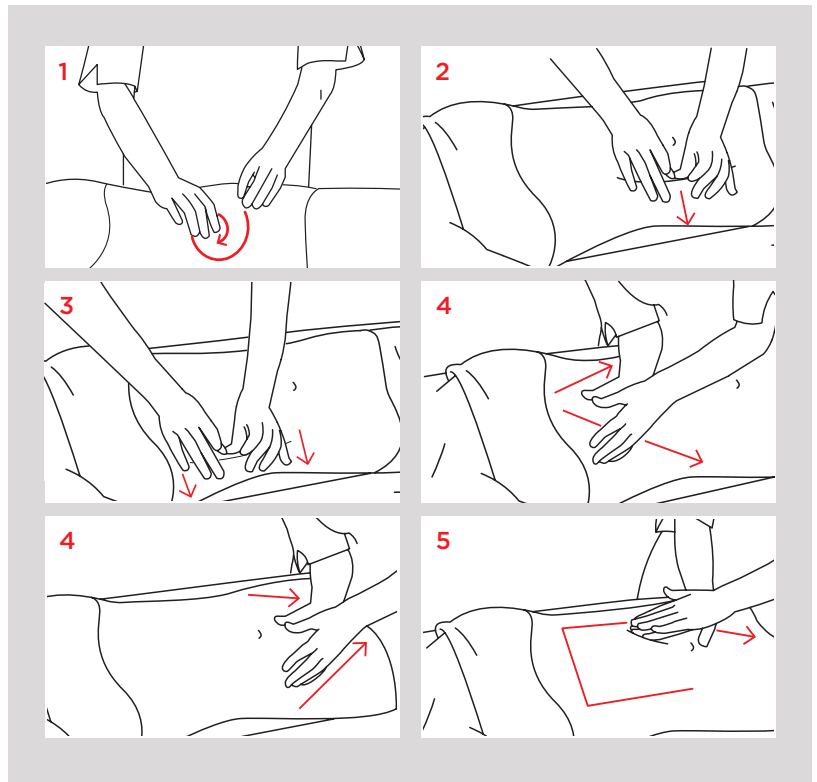

PRONE POSITION LOWER LIMBS

1. Warming friction along the twin muscles
2. Forward and backward twisting of the twin muscles
3. Hammer percussion massage along the twin muscles
4. Warming friction on the sides of the thigh
5. Horizontal roulage of the fascia lata inwards
6. Vertical roulage on the entire buttock area
7. Hammer percussion massage on thigh and buttock

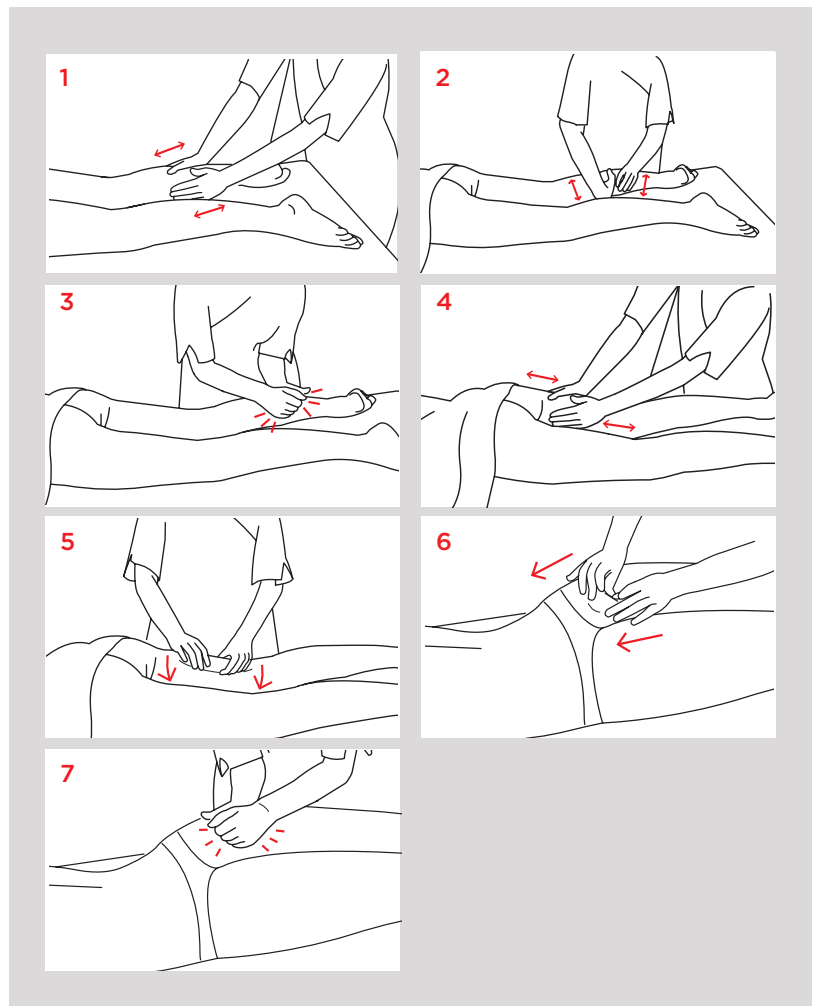

Compact Cellulite and Localized Fat*

COFFEE-SHAPE DOUBLE ACTION TREATMENT CLINICALLY TESTED EFFECTIVENESS

MOKA ACTIVE SCRUB

coffee
brown sugar and sea salt
rice oil

500 ml / 16.9 fl. oz US

Intense body **exfoliating treatment**. In synergy with the massage, it promotes a **strong draining and reactivating action** that reduces the appearance of imperfections linked to compact cellulite and localized adiposity.

MOKA LIPO SERUM

coffee
metilxantine
maca

250 ml / 8.4 fl. oz US

Concentrated serum with an **intensive action** aimed at the imperfections of **localized fat deposits** and **compact cellulite** on the belly, thighs, hips and buttocks area. Associated to the **Vacuum Lipo Massage**, it remodels and redefines the silhouette, giving elasticity and firmness to the skin.

MOKA HOT MUD

coffee silverskin
green and pink clay
niocell complex

500 ml / 16.9 fl. oz US

Mud massage cream with a **thermogenic action**. It combines the detox and remineralizing properties of clays with the draining and reactivating action of the massage. **Visibly reshapes the contours of the body** weighed down by localized fat deposits and compact cellulite.

WARNINGS: it can cause heat that disappears in a short time. Wash hands thoroughly after use or use gloves.



* Targeted to the imperfections of compact cellulite and localized fat



Discover More

Coffee-Shape Treatment

STEP 1: MOKA ACTIVE SCRUB

Mix and spread evenly about 50 g of scrub on the lower limbs and abdomen.

Massage for a few minutes, insisting on thickened areas (knees, heels).

Remove with microfiber cloth, shower or wet sponge bath knobs.



STEP 2: BODY BEAUTY EXPERIENCE* Relaxing touch and Draining touch*

a) Relaxing touch: apply a few drops of **BIOAROMA** RELAXING EQL OIL on the areas of greatest tension.

b) Draining touch: apply a few drops of **BIOAROMA** ENERGY DRN OIL on the lymph nodes.



STEP 3: MOKA LIPO SIERO and VACUUM LIPO MASSAGE*

Massage about 25 ml of serum on the thighs, buttocks, abdomen and hips.

Perform the VACUUM LIPO MASSAGE using the specific silicone cup.



STEP 4: MOKA HOT MUD and BODY BEAUTY EXPERIENCE Firming touch*

Apply about 50 ml of mud on the lower limbs and abdomen.

Massage with energetic and stimulating movements until completely absorbed.

Dab any residual product.

Finish by performing the BODY BEAUTY EXPERIENCE Firming touch.

! See recommendations/warnings in the relevant professional products sections

*BBE details and sequences on pages 12-13-14-15; VACUUM LIPO MASSAGE sequences on pages 30-31

Vacuum Lipo Massage

Vacuum Lipo Massage is a functional massage technique that characterizes the **Coffee-Shape treatment**. It was developed by the Boline Jatò laboratories to act in a targeted and deep way on the imperfections linked to **compact cellulite** and **localized fat**.

HOW IT WORKS

Thanks to a particular sequence of recurring movements and exploiting the **mechanisms of the aspirated vacuum** of the special Boline Jatò **silicone cup**, the Vacuum Lipo Massage improves the appearance of the epidermis specifically in the areas with fat deposits.

The **silhouette looks remodelled and redefined**, toxins and excess liquids are drained. The microcirculation is reactivated and the blood flow in the treated areas increased, making the skin tissue more oxygenated, compact and bright.

FRONT LEG:

1. Vacuum above the kneecap (back and forward)
2. Corkscrew vacuum above the kneecap (back and forward)
3. Inner thigh: zig-zag vacuum in accompaniment with the other hand (only forward)
4. Vertical vacuum on the inner thigh
5. Quadriceps femoris: zig-zag vacuum in accompaniment with the other hand
6. Corkscrew vacuum on the quadriceps
7. Vertical vacuum on the quadriceps
8. Bent leg: circular vacuum along the fascia lata (the other hand follows the movement)
9. Corkscrew vacuum on the fascia lata
10. Vertical vacuum along the fascia lata

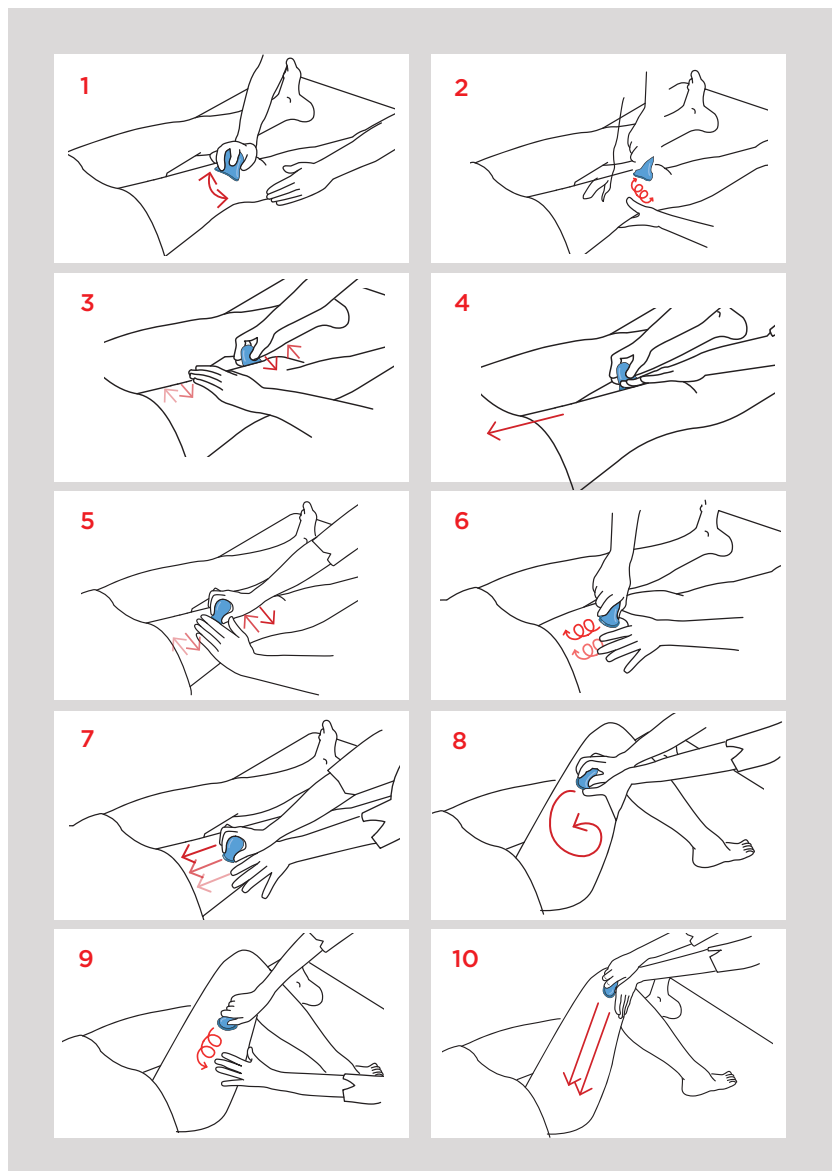

ABDOMEN (stand on the left side):

- 11. Static vacuum on the navel
- 12. Zig-zag vacuum on mid abdomen
- 13. Perpendicular vacuum on the rectus abdominis (only the cup works)
- 14. Vertical corkscrew vacuum on the rectus abdominis in three lines
- 15. Zig-zag vacuum on the ribs and costal arch (only the cup works)

Repeat all movements on the other side, from the movement n.12

- 16. Circular draining vacuum towards the colon and static vacuum on the colon

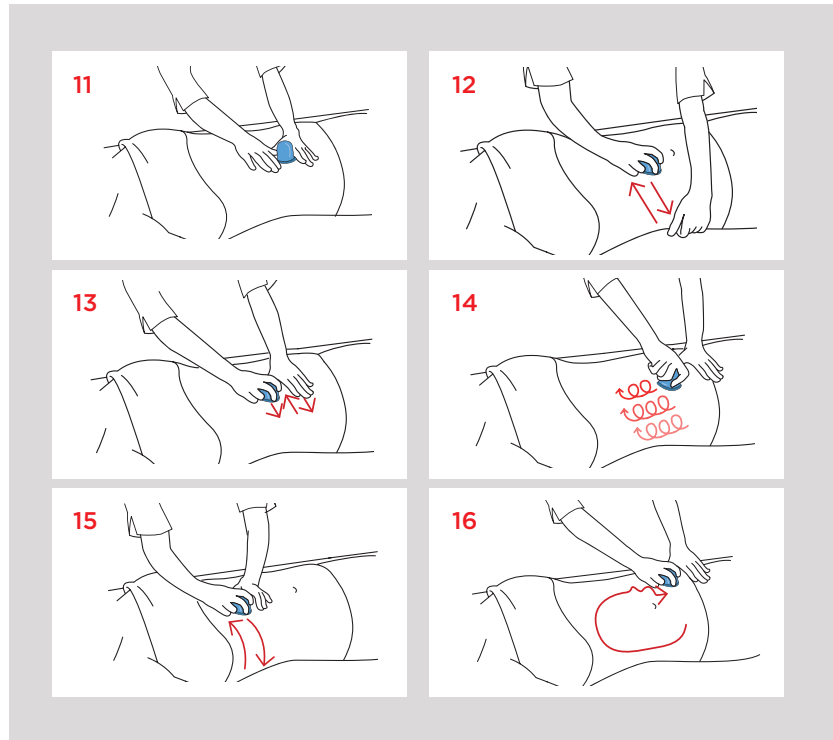

BACK LEG:

- 17. Zig-zag vacuum on femoral biceps and fascia lata until gluteus line
- 18. Corkscrew vacuum in many lines
- 19. Vertical vacuum on femoral biceps and gluteus
- 20. Gluteus line: zig-zag vacuum in accompaniment with the other hand
- 21. Corkscrew vacuum along gluteus line
- 22. Zig-zag vacuum and circular vacuum on the gluteus
- 23. Zig-zag vacuum on the back of the iliac crest
- 24. Vacuum from sacrum outwards

Repeat the movements on the other leg

- 25. Radial vacuum around the sacrum
- 26. Static vacuum on the sacrum

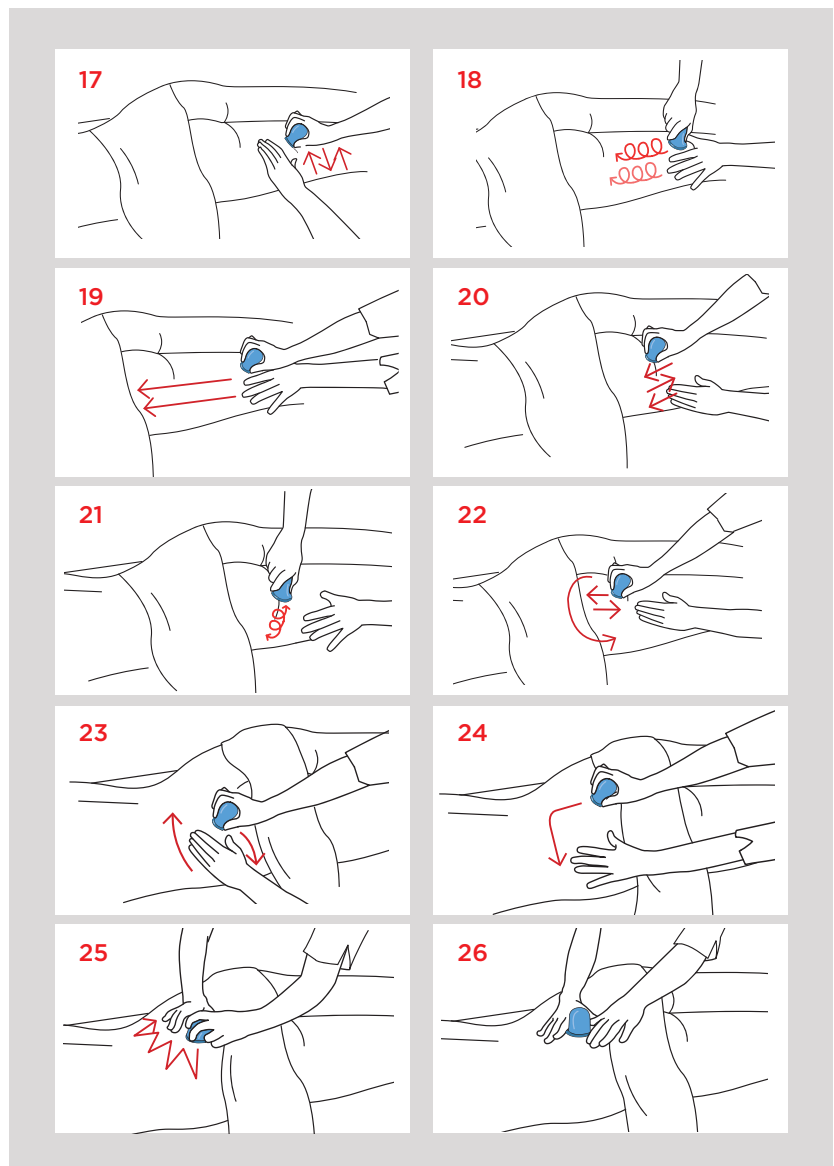

Localized and Widespread Adiposity*

ADI-SHAPE TARGETED TREATMENT CLINICALLY TESTED EFFECTIVENESS

THERMOSHAPE VOLCANIC MUD

liporeducer complex
volcanic sand
orange extract
ginger

1000 g - 35.2 oz US

The effectiveness of a mud combined with the texture of a cream. An **intensive treatment** that smoothes the skin, making it soft and supple. Innovative, functional, stimulating and thermogenic complexes **reduce the appearance of the blemishes localized on the abdomen, hips, thighs and buttocks.**

RECOMMENDED:

- *for treating localized fat deposits, in men as well*

WARNINGS: Water can appear on mud surface: slight separation of the mud is natural and does not alter the product's properties. If this occurs, mix the product before use. This product contains hyperemic substances which may cause a slight tingling, accompanied by a sensation of heat and redness, which disappears within a few minutes.



ADI-SHAPE SERUM

turmeric
capsicum
nioshape complex

150 ml 5.0 fl oz US

Remodeling synergy with an intensive thermogenic action for high-impact treatment of the blemishes caused by **localized and widespread adiposity.** The effectiveness of the formula is enhanced by the innovative Niosomal Technology.

WARNINGS: this product is hyperemic and may cause redness. Apply using gloves.



LIPOSHAPE CREAM

liporeducer complex
coffee oil
cinnamon extract
ivy extract

1000 g - 35.2 oz US

Enhanced formula rich in functional substances for a stimulating action **which minimizes the look of imperfections related to localized fat deposits.** A synergy of plant extracts and oils, which are valuable sources of vitamins and mineral salts, preserves the elasticity of the skin, improving its vitality.

RECOMMENDED:

- *for performing **Bioline Jatò massages: Shaping, Jatòwell and DDM (Deep Draining Massage).***



* Targets the blemishes caused by localized and widespread adiposity



Discover More

Adi-Shape Treatment

BODY BEAUTY EXPERIENCE Relaxing touch and Draining touch*

a) **Relaxing touch:** apply a few drops of **BIOAROMA** RELAXING EQL OIL to areas of greatest tension.

b) **Draining touch:** applying a few drops of **BIOAROMA** ENERGY DRN OIL to the lymphatic ganglions.



THERMOSHAPE VOLCANIC MUD

Warm up approximately 100 g of mud in a bain-marie.

Massage on legs, thighs, buttocks and abdomen with energetic movements.

Wrap with a disposable sheet and leave on for approximately 15', then remove with a microfiber cloth or shower.



ADI-SHAPE SERUM

Apply approximately 15 ml of serum on legs, thighs, buttocks and abdomen.

Massage vigorously with circular movements.



LIPOSHAPE CREAM and ZERO-CELL STIMULATION*

Apply 10 g of product evenly on treated areas and perform the ZERO-CELL STIMULATION.

! ZERO-CELL STIMULATION REPLACES BODY BEAUTY EXPERIENCE FIRMING TOUCH WITH STIMULATING AND TONING ACTION.

! See recommendations/warnings in the relevant professional products sections

*BBE details and sequences on pages 12-13-14-15; ZERO-CELL STIMULATION sequences on pages 26-27

Swollen Legs

SCULPT & DRN BANDAGE LOCALIZED TREATMENT

DRN ACTIVE ANTI-WATER CONCENTRATE

cell-reverse seaweed
escin
caffeine
lemon extract

100 ml - 3.3 fl. oz US

Highly effective concentrated gel serum for the body. A complex of functional substances, which **minimizes the appearance of orange peel skin** and provides a feeling of **instant lightness**. The multi-action texture promotes tissue elasticity and helps to keep a smooth and compact look.

RECOMMENDED:

- *in the case of fragile skin, swelling and heaviness of the lower limbs - even during pregnancy.*



SCULPT & DRN BANDAGE

cell-reverse seaweed
sea salts
birch extract
green coffee extract

3 single dose sachets of 250 ml with
2 bandages each sachet -
3 x 8.4 fl. oz US

Formula with a high concentration of salt that, combined with the controlled compressive action of the bandage, enhances the effectiveness of the treatment. It promotes skin elasticity and firmness, **reducing the look of cellulite and fat deposits**.

RECOMMENDED:

- *for swelling and heaviness in the lower limbs for an immediate sensation of lightness and wellbeing.*



DRN CELL OIL

escin
argan oil
ginkgo extract

500 ml - 16.9 fl.oz US

Precious plant oils **promote tissue elasticity** and help to maintain a **smoother skin** reducing the look of imperfections caused by cellulite. For a soft and hydrated skin.

RECOMMENDED:

- *for very dry and dehydrated skin*
- *for performing **Bioline Jatò massages: Shaping, Jatòwell and DDM (Deep Draining Massage).***





Discover More

Sculpt & Drn Bandage Treatment

BODY BEAUTY EXPERIENCE Relaxing touch and Draining touch*

a) Relaxing touch: apply a few drops of **BIOAROMA** RELAXING EQL OIL to areas of greatest tension.

b) Draining touch: apply a few drops of **BIOAROMA** ENERGY DRN OIL to the lymphatic ganglions.



DRN ACTIVE ANTI-WATER CONCENTRATE

Apply 10 ml of product on feet, legs, thighs and buttocks.

Finish with a pneumatic massage or a pressotherapy session.

! The amphoteric formulation of the product allows combination with aesthetic equipment (ultrasound, electroporation).



SCULPT & DRN BANDAGE

Wring out the wraps well and apply by wrapping the legs, from the foot up to the groin.

Cover with a disposable sheet and leave on for 15-20'.



DRN CELL OIL

Apply 10 ml of product evenly on treated areas.



Finish with the BODY BEAUTY EXPERIENCE **Firming touch***.

THESE TREATMENTS CAN BE INCLUDED WITHIN THE ALGO-CELL AND ADI-SHAPE PATHS (SEE BODY BEAUTY PROJECT SECTION) TO INTENSIFY AND STRENGTHEN THEIR EFFECTIVENESS, OR THEY CAN BE OFFERED ON A ONE-OFF BASIS.

! See recommendations/warnings in the relevant professional products sections

*BBE details and sequences on pages 12-13-14-15

Localized Adiposity*

SCULPT & LIPO BANDAGE LOCALIZED TREATMENT

LIPOACTIVE THERMOGENIC CONCENTRATE

liporeducer complex
green coffee extract
guarana extract
oleoresin capsicum

100 ml - 3.3 fl. oz US

Concentrated gel serum for the body with a warming effect. It **reduces the appearance** of blemishes caused by **adiposity on abdomen, thighs and buttocks**.

WARNINGS: this product is hyperemic and may cause redness. Apply using gloves.

SCULPT & DRN BANDAGE

cell-reverse seaweed
sea salts
birch extract
green coffee extract

3 single dose sachets of 250 ml with 2 bandages each sachet - 3 x 8.4 fl. oz US

Formula with a high concentration of salt that, combined with the controlled compressive action of the bandage, enhances the effectiveness of the treatment. It promotes skin elasticity and firmness, **reducing the look of cellulite and fat deposits**.

LIPOSHAPE CREAM

liporeducer complex
coffee oil
cinnamon extract
ivy extract

1000 g - 35.2 oz US

Enhanced formula rich in functional substances for a stimulating action **which minimizes the look of imperfections related to localized fat deposits**. A synergy of plant extracts and oils, which are valuable sources of vitamins and mineral salts, preserves the elasticity of the skin, improving its vitality.

RECOMMENDED:

- for performing **Bioline Jatò massages: Shaping, Jatòwell and DDM (Deep Draining Massage)**.



* Targets the blemishes caused by localized adiposity



Discover More

Sculpt & Lipo Bandage Treatment

BODY BEAUTY EXPERIENCE Relaxing touch and Draining touch*

a) Relaxing touch: apply a few drops of **BIOAROMA** RELAXING EQL OIL to areas of greatest tension.

b) Draining touch: apply a few drops of **BIOAROMA** ENERGY DRN OIL to the lymphatic ganglions.



LIPOACTIVE THERMOGENIC CONCENTRATE

Apply 10 ml of product to the zones affected by localized adiposity.

Finish with a pneumatic massage.

! The amphoteric formulation of the product allows combination with aesthetic equipment (ultrasound, electroporation).



SCULPT & DRN BANDAGE

Wring out the wraps well and apply by wrapping the thighs, buttocks and abdomen.

Cover with a disposable sheet and leave on for 15'-20'.

! For stomach treatments only, apply both wraps on the waist if needed.

Can also be used on arms.



LIPOSHAPE CREAM

Apply 10 g of product evenly on treated areas.



Finish with the BODY BEAUTY EXPERIENCE **Firming touch***.

THESE TREATMENTS CAN BE INCLUDED WITHIN THE ALGO-CELL AND ADI-SHAPE PATHS (SEE BODY BEAUTY PROJECT SECTION) TO INTENSIFY AND STRENGTHEN THEIR EFFECTIVENESS, OR THEY CAN BE OFFERED ON A ONE-OFF BASIS.

! See recommendations/warnings in the relevant professional products sections

*BBE details and sequences on pages 12-13-14-15



Bioline Jatò

Body Massages

The Massage is one of the most **powerful forms of communication**, a natural and instinctive gesture. The simple touch of the hands conveys trust and warm-heartedness, it is contact and also sharing. Through the Conscious Touch of the Operator and the Relaxation of the Customer an exchange that transcends language takes place, capable of balancing both body and mind.

It involves **sensitivity and delicacy** in asking and offering, understanding the language of each body, **respect for different timings** and means, and even discretion, care and listening (the breath rhythm, the heartbeat and the silence). A well-performed massage amplifies the sensations and the ability of those who receive it to feel their body and to connect with their inner being, to rediscover an all-round well-being.

Bioline Jatò has always been attentive to the development of new **functional** and innovative **massage techniques**. The brand offers a wide range of manual skills aimed at relaxation and treatment of the main body blemishes.

There are four Bioline Jatò massage techniques for a perfect remise-en-forme and a **unique experience** that combines **well-being and effectiveness**.

Moments of intense involvement for a total renewal of mind and body that create ideal treatment rituals both in the Bioline Jatò Beauty Centers and in SPAs.

DTM - DEEP TISSUE MOBILIZATION

DECONTRACTING MASSAGE

- **WHAT IS:** **decontracting** massage
- **EFFECTS:**
 - **improves tissue elasticity** and promotes relaxation of muscular tension
 - promotes a draining and reducing effect
 - favors the **reduction of lymphatic stagnation**
 - **stimulates microcirculation**
- **SUITABLE FOR:** blemishes related to **compact cellulite, water retention and fat**
- **WHERE IT WORKS:** feet, lower body, abdomen, back



PRODUCTS USED:

- **Bioaroma Normalizing DTX Oil:** apply a few drops on the sole of the foot, cellulite and intoxicated areas
- **Bioaroma Energy DRN Oil:** apply a few drops on the gastrocnemius (twin muscles) and popliteal cavity
- **Bioaroma Relaxing EQL Oil:** apply a few drops on paravertebral gutters
- **Lipoactive Thermogenic Concentrate:** apply on areas with compact cellulite and/or fat (to intensify the action of massage)
- **Hydrasource Body Lotion:** distribute on the skin in order to favour the flow of the manoeuvres (only in case of dry skin)

*! It can be combined with all body treatments to promote immediate and visible results. It is particularly recommended in combination with **Adi-Shape** and **Coffee-Shape**.*



DDM - DEEP DRAINING MASSAGE

DETOXINATING MASSAGE

- **WHAT IS:** **detoxinating** and **draining** massage
- **EFFECTS:**
 - promotes the **fluids mobilization**
 - favors the **elimination of waste and toxins**
 - improves the **tissues' sponginess and mobility**
 - drains the **subcutis**
 - **relieves the feelings of heavy legs**
- **SUITABLE FOR:** imperfections related to **infiltrated and fibrous cellulite**, infiltrated adipose tissue, musculature full of waste and toxins
- **WHERE IT WORKS:** lower body, arms and back



PRODUCTS USED:

- **Bioaroma Energy DRN Oil:** add a few drops to the massage product used
- **Drn Active Anti-Water Concentrate:** apply on legs (to intensify the action of massage)
- **Drn Cell Oil or Liposhape Cream:** distribute on the skin in order to promote a draining or lipolytic action

*! It can also be proposed as a valid preparation technique for different Body Concept treatments, especially **Meso-Fit** and **Algo-Cell**.*



SHAPING

DRAINING AND LIFTING EFFECT MASSAGE

- **WHAT IS:** **draining and lifting effect** massage
- **EFFECTS:**
 - favors the **drainage** and the **relaxation of muscular tension**
 - **intensely tones** the skin tissues, improves the look of the silhouette
 - restores the energy balance in the tissues
- **PHASES:**
 - **1st draining, reducing and relaxing phase**
 - **2nd toning and lifting phase**
- **SUITABLE FOR:** promote the elimination of excess fluids and tone
- **WHERE IT WORKS:** total body



PRODUCTS USED:

- **Bioaroma Relaxing EQL Oil or Energy DRN Oil or Softening Dec Oil:** add directly to the massage product to promote a relaxing, draining or toning action
- **Drn Active Anti-Water Concentrate and/or Lipoactive Thermogenic Concentrate:** apply optionally in case of water retention and/or fat (to intensify the action of the massage)
- **Drn Cell Oil or Liposhape Cream:** distribute on the skin in order to promote a draining or lipolytic action



JATÒWELL

WELLNESS MASSAGE

- **WHAT IS:** **Psycho-Neuro-Connective holistic** massage
- **EFFECTS:**
 - on the **psyche:** stimulates the restoration of the normal **psycho-physical balance**
 - on the **nervous system:** combines a **deep relaxation** to a feeling of well-being
 - on the **connective tissue:** promotes an **oxygenating** and **revitalizing** action on skin tissues and improves the skin elasticity
- **SUITABLE FOR:** reducing stress, tension and muscle contractures
- **WHERE IT WORKS:** total body



PRODUCTS USED:

- **Bioaroma Relaxing EQL Oil:** add a few drops to the massage product used
- **Drn Active Anti-Water Concentrate and/or Lipoactive Thermogenic Concentrate:** apply at choice in case of water retention and/or fat (to intensify the action of the massage)
- **Drn Cell Oil or Liposhape Cream:** distribute on the skin in order to promote a draining or lipolytic action



For a deeper study of the four Bioline Jatò body massages, it is possible to view the dedicated brochures and specific videos

Homecare Products

Exfoliating and cleansing

THALASSO FORCE SCRUB

sea salt, sweet almond oil, seaweed extracts
650 g - 22.9 oz US

An original two-phase formula that combines an exfoliating, regenerating and stimulating action. **It smooths, moisturizes and revitalizes the skin. Ideal for dry, sensitive skin, all types of cellulite.**



SCRUB GOURMET

kiwi, chlorophyll, spirulina
60 g x 5 - 2.1 oz x 5

Body scrub with an active formula and an inviting, ultrasensory texture. **Smooths and deeply purifies** the skin, leaving it soft and firm. Transforms exfoliation into a ritual of deep wellbeing. **Ideal for young, hyperkeratotic skin with impurities.**



VITALITY SHOWER GEL

cell-reverse seaweed, marine trace elements, goji berries, polynesian lagoon water
250 ml - 8.4 fl. oz US

A gentle shower gel that **cleanses and revitalizes the skin**, preserving its natural protective defenses. A fulfilling shower experience to reawaken your senses and recharge your body with renewed wellbeing.



Moisturizing, leg wellness and nourishing

HYDRASOURCE BODY LOTION

pro-elasticity complex, aloe extract, white lily extract, wholegrain rice milk
250 ml - 8.4 fl. oz US

The formula with a melting texture is pleasant to apply and gently fragranced. **It intensely nourishes and quenches the skin**, keeping it supple, bright and delightfully soft.



CRYOACTIVE LIGHT LEGS GEL

menthol, troxerutin, blueberry
200 ml - 6.7 fl. oz. US

Fast-absorbing relief gel with an “ice” effect. **Energizes and revives swollen, tired and weary legs**, promoting an intense and prolonged sensation of freshness and lightness.



Blemishes caused by cellulite and adiposity

RE-SHAPE BOOSTER SERUM

caffeine, carnitine, nioshape complex
150 ml 5.0 fl. oz US



Reshaping booster serum with an **intensive action** and a **thermogenic effect**. Ideal in case of blemishes caused by **cellulite and adiposity** in critical areas of the body. With innovative **Niosomal Technology** for enhanced effectiveness.

REDUCELL ACTIVE CREAM

cell-reverse seaweed, caffeine,
escin phytosome, sweet almond oil
250 ml - 8.4 fl. oz US



A gel cream rich in concentrated functional substances that **reduce the appearance of the skin imperfections caused by cellulite** and give the skin softness and elasticity.

PRO-SLIM SALINE CREAM

sea salt, nocturslim, seaweed extracts
250 ml - 8.4 fl. oz US



An intensive treatment-cream, with high salt concentration, formulated to take advantage of the skin's nightly biorhythms and to **reduce the appearance of skin imperfections caused by cellulite and localized adiposity**.

LIPOACTIVE THERMO CREAM

liporeducer complex, guarana extract,
bitter orange extract, ivy extract
250 ml - 8.4 fl. oz US



Enhanced formula with thermogenic effect providing a **visible action on abdomen, thighs and buttocks**. It promotes tissue elasticity and reduces the appearance of body blemishes.

Aged skin and loss of tone

SKIN TONE ELASTICIZING CREAM

pro-elasticity complex, plant collagen, NMF,
sweet almond oil
250 ml - 8.4 fl. oz US



Dermo-restoring **breast and body** treatment formulated to reduce the appearance of loose skin and **stretch marks**. It **promotes skin elasticity and hydration**.

PHYTOVITAMIN DRY OIL

vitamins A and E, roucou oil, jojoba oil
150 ml



A combination of high-quality plant oils in a fast absorbing and smooth-gliding texture. Its **non-greasy** formula nourishes the skin, giving it **softness and radiance**.

NUTRISENSE WELLNESS CREAM

rice extract, shea butter, smithsonite extract
250 ml



An exclusive formula with an ultra **rich and melting texture** that gives the skin **hydration and intense nourishment**, and helps minimizing the appearance of signs of aging.





Body Beauty Project

WHAT IS IT

A **complete program** to reshape the silhouette and work on critical areas. A practical, effective and pleasant system **to get the body back in shape quickly** with the possibility of maintaining the results obtained throughout the year.

HOW IT WORKS

1. Carry out an accurate check-up of the client using the **Bioline Jatò Body Consultation Sheet** to identify the most visible blemishes to be treated
2. Identify the most suitable treatments and/or path, based on the client's blemishes and needs
3. Suggest the most suitable **homecare products**, essential to enhance the effectiveness of the treatments

Bioline Jatò has developed four **effective treatments**, with **clinically tested results**, in just 2 weeks.

MESO-FIT

BROAD SPECTRUM TREATMENT

cellulite, fat and sagging skin¹

ALGO-CELL

TARGETED TREATMENT

infiltrated and fibrous cellulite²

COFFEE-SHAPE

DOUBLE ACTION TREATMENT

compact cellulite and localized fat³

ADI-SHAPE

TARGETED TREATMENT

localized and widespread fat⁴



SUITABLE FOR:

1. An effective remise-en-forme with visible results
2. Last minute and those who have little time
3. Not particularly visible and stubborn blemishes

METHODS AND TIMINGS

We work on the single subject with only one type of treatment, according to the blemish to be treated

—

2 treatments per week for 2 weeks (total 4 treatments).

1. Blemishes caused by cellulite, localized adiposity, sagging skin 2. Blemishes caused by infiltrated and fibrous cellulite 3. Blemishes caused by compact cellulite and localized fat 4. Blemishes caused by localized and widespread fat deposits

The Protagonists of the

1. MESO-FIT BROAD SPECTRUM INTENSIVE TREATMENT *cellulite, fat and sagging skin*¹

With the **BRUSH DRAINING MASSAGE**, a functional massage is performed with a brush, to smooth, drain and reshape the body, for an immediate sensation of lightness and for a skin with a more compact and elastic appearance.

Clinically tested effectiveness² INSTRUMENTAL RESULTS

REDUCES THE CIRCUMFERENCE OF THE ABDOMEN	
AFTER 1 TREATMENT ³	AFTER 4 TREATMENTS ⁴
up to - 2 cm	up to - 2,60 cm
average - 0,14 cm	average - 0,82 cm

REDUCES THE CIRCUMFERENCE OF THE THIGH	
AFTER 1 TREATMENT ³	AFTER 4 TREATMENTS ⁴
up to - 2 cm	up to - 4,5 cm
average - 0,61 cm	average - 1,43 cm



¹ Blemishes caused by cellulite, localized adiposity, sagging skin.
² Instrumental clinical test carried out by an independent institute on 19 volunteers with cellulite. Professional and homecare products tested: BIOAROMA Relaxing EQL Oil and Energy DRN Oil, BODY CONCEPT Meso-Fit DTX Mask, Meso-Fit Hot Green Mud, Meso-Fit Active Gym Serum, Reducell Active Cream, Pro-Slim Saline Cream.
³ Clinical results after 1 treatment (professional treatment and homecare products).
⁴ Clinical results after 4 treatments and a 2-week period (professional treatment and homecare products).

2. ALGO-CELL TARGETED TREATMENT *infiltrated and fibrous cellulite*⁵

With the **ZERO-CELL STIMULATION** massage, a combination of manoeuvres capable of stimulating the tissues in depth, for a draining, recompacting and microcirculation-improving action.

Clinically tested effectiveness⁶ INSTRUMENTAL RESULTS⁷

REDUCES THE CIRCUMFERENCE OF THE THIGH	
AFTER 4 TREATMENTS	
up to - 2,5 cm	average - 0,45 cm

REDUCES ABOVE THE KNEE CIRCUMFERENCE	
AFTER 4 TREATMENTS	
up to - 2 cm	average - 0,63 cm



⁵ Blemishes caused by infiltrated and fibrous cellulite.
⁶ Clinical test carried out by an independent institute on 19 volunteers with cellulite, for a period of 2 weeks. Professional and homecare products tested: BIOAROMA Relaxing EQL Oil and Energy DRN Oil, BODY CONCEPT Algo Drn Marine Mud, Algo-Cell Serum, Drn Cell Oil, Reducell Active Cream, Pro-Slim Saline Cream.
⁷ Results after 4 treatments and a period of 2 weeks (professional treatment and homecare products).

Body Beauty Project

3. COFFEE-SHAPE

DOUBLE ACTION TREATMENT

compact cellulite and localized fat¹

With **VACUUM LIPO MASSAGE**, a massage performed with a silicone cup with draining and reactivating action, works on the critical points that appear remodelled and sculpted.

Clinically tested effectiveness² INSTRUMENTAL RESULTS

REDUCES THE CIRCUMFERENCE OF THE ABDOMEN	
AFTER 1 TREATMENT ³	AFTER 4 TREATMENTS ⁴
up to - 2 cm	up to - 3 cm
average - 0,28 cm	average - 1,30 cm

REDUCES THE CIRCUMFERENCE OF THE HIPS	
AFTER 1 TREATMENT ³	AFTER 4 TREATMENTS ⁴
up to - 1 cm	up to - 2 cm
average - 0,35 cm	average - 1,13 cm



¹ Blemishes caused by compact cellulite and localized fat
² Instrumental clinical test carried out at an independent institute on 20 volunteers with compact cellulite blemishes and localized fat for a period of two weeks, 4 treatments. Professional and homecare products tested: BIOAROMA Relaxing EQL Oil and Energy DRN Oil, BODY CONCEPT Coffee-Shape Moka Active Scrub, Coffee-Shape Moka Lipo Serum, Coffee-Shape Moka Hot Mud, Reducell Active Cream, Pro-Slim Saline Cream.
³ Clinical results after 1 treatment (professional treatment and homecare products).
⁴ Clinical results after 4 treatments and a period of 2 weeks (professional treatment and homecare products).

4. ADI-SHAPE

TARGETED TREATMENT

localized and widespread fat⁵

With **ZERO-CELL STIMULATION** massage, a combination of manoeuvres capable of stimulating the tissues in depth, favours remodelling and a visible toning action.

Clinically tested effectiveness⁶ INSTRUMENTAL RESULTS⁷

REDUCES THE CIRCUMFERENCE OF THE ABDOMEN	
AFTER 4 TREATMENTS	
up to - 4,5 cm	average - 1,84 cm

REDUCES THE CIRCUMFERENCE OF THIGH	
AFTER 4 TREATMENTS	
up to - 2,5 cm	average - 0,71 cm



⁵ Blemishes caused by localized and widespread fat deposits
⁶ Clinical test carried out by an independent institute on 19 volunteers with fat deposits, over a period of two weeks. Professional and homecare products tested: BIOAROMA Relaxing EQL Oil and Energy DRN Oil, BODY CONCEPT Thermoshape Vulcanic Mud, Adi-Shape Serum, Liposhape Cream, Lipoactive Thermo Cream, Pro-Slim Saline Cream.
⁷ Results after 4 treatments and a period of 2 weeks (professional treatment and homecare products).

The Paths of the Body Beauty Project

Bioline Jatò has created **2** clinically tested treatments, targeted and differentiated **according to the blemish** to be treated. Each path includes specific massage techniques and highly concentrated products that work in synergy to guarantee **IMMEDIATE and PROGRESSIVE RESULTS**.

They are indicated for:

1. A specific and gradual action on the blemish
2. Those seeking visible and long-lasting results
3. More severe and marked blemishes

Methods and timing

We work on the individual subject combining different types of treatments that act in synergy on the blemishes to be treated.

PATH A

WATER RETENTION,
INFILTRATED AND FIBROUS CELLULITE¹

PATH B

COMPACT CELLULITE,
LOCALIZED AND WIDESPREAD FAT²

The paths are structured in 3 phases:

1. INTENSIVE PHASE

With a **targeted action** on blemishes, to stimulate the metabolism and awaken slowed-biorhythms.

2. REINFORCEMENT PHASE

If after the Intensive Phase there is the **need to further refine** the results obtained.

3. MAINTENANCE PHASE

Based on the client's blemish, a **personalized path** can be created with the aim of keeping the body in shape all year round, without starting from scratch.

The effectiveness of the paths is guaranteed by the **Bioline Jatò® System method** tested over the years and is based on the concept of **alternation and diversification** of treatments and homecare products.

In this way it can be stimulated the functional memory of the body that allows to keep active the functional processes started all year round.

Each path consists in specially studied protocols targeted to the body blemishes, for **clinically tested, visible and long-lasting results**.

1. Blemishes caused by water retention, infiltrated and fibrous cellulite 2. Blemishes caused by compact cellulite, localized and diffused fat

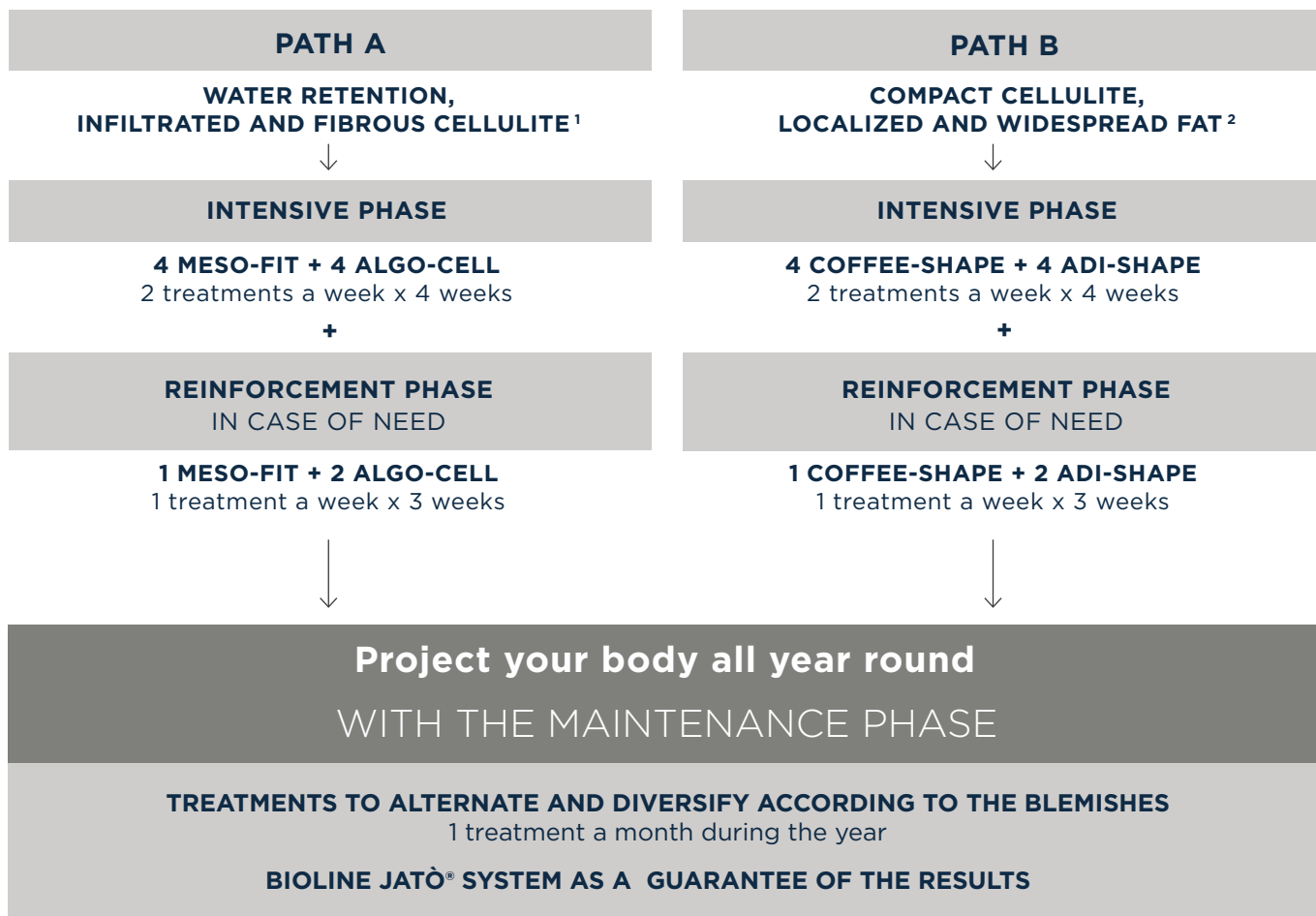

THE ROUTINE TREATMENT

SCRUBS AND EXFOLIATORS

Start each cycle of treatments or path with an exfoliating treatment, **for a detox action that prepares the skin** to receive the products applied subsequently:

Exfo Marine

salt crystals scrub, ideal for **thick skin**, deeply renovates and **revitalizes the skin**

Glyco Peel

renovating fluid, ideal also for **delicate parts**, exfoliates, **smooths and recompacts**



BANDAGES

Enhance results by providing in the middle or at the end of each treatment path, one or more applications of:

Sculpt&Drn Bandage

ideal for **swollen legs**, intensifies the draining action and gives an **immediate sensation of lightness**

Sculpt&Lipo Bandage

ideal for **localized fat** on thighs, abdomen and buttocks, **diminishes the visibility** of the skin blemishes connected to the **fat deposits**



1. Blemishes caused by water retention, infiltrated and fibrous cellulite 2. Blemishes caused by compact cellulite, localized and diffused fat



Warnings

These cosmetic products are for professional use and it is therefore **important to follow the above instructions carefully.**

The esthetician is required to inform the consumer about the information contained in the precautions and warnings.

Check the ingredient list for any intolerances or allergies before use.

For particularly sensitive individuals a tolerance test is recommended, by applying the product to the forearm and sealing with a patch for 24 hours.

Be careful when performing the treatment on individuals who are pregnant.

After application, **close the packaging carefully and store at room temperature in a dry place, away from light and heat sources.**

Avoid mixing with different substances or products which are not included in the specific instructions.

For external use only.

Avoid contact with eyes, mucous membranes and skin that is broken, irritated or affected by pathologies.

In case of contact with eyes, rinse thoroughly with running water.

No danger under normal conditions of use.

Do not swallow. Keep out of the reach of children.

To consolidate and to progressively improve the results achieved, **it is essential to undergo treatment regularly in the salon, as well as using the products for home use recommended by the esthetician.**

THE NATURAL INGREDIENTS IN THE FORMULATIONS MAY CAUSE SLIGHT VARIATIONS IN COLOR, ODOR AND/OR VISCOSITY IN THE PRODUCTS, WHICH DO NOT AFFECT THEIR AESTHETIC FUNCTIONALITY

TIPS TO SANITIZE TOOLS

Sanitize and dry carefully the tools **before every use**, according to the sanitizing protocols of the specific **file “How to sanitize the accessories”** and according to the sanitary regulation of your area.

TO CONSULT THE “HOW TO SANITIZE THE ACCESSORIES” SHEET:



This manual is for professional exclusive use and it is not to be disclosed.



SCAN THE QR CODE AND
DISCOVER MORE!



BIO LINE S.r.l.
Società Benefit
MADE IN ITALY

Viale Bolognini 78
38122 Trento Italy
+39 0461 933209
bioline@bioline-jato.com
www.bioline-jato.com

